

Lifting Instructions TopLight Roof Access Hatches

Important note



- The TopLight roof access hatches range from approx. 370 kg to approx. 510 kg. For safety reasons we recommend never walking under the hatch during lifting operations.

Type	Inside dimensions	Outside dimensions	Weight
TL2010-UG	2000x1000 mm	2330 x 1250 mm	+/- 370 kg.
TL3010-UG	3000x1000 mm	3330 x 1250 mm	+/- 510 kg.

- Be sure to always use **approved**, well maintained lifting accessories and equipment. The lifting accessories and the crane must be suitable for lifting the weights listed above.
- Never stand on the roof access hatch while attaching the lifting chains/lifting cables, as this can result in damage to the glazing.
- Lift and set down the roof access hatch as gently as possible, to prevent damage.

Requirements

- 4x Shackle 'Green Pin G-4161 Screw Pin Bow Shackle' or equivalent. With Ø8 mm pin.
- 1x Double lifting beam
- 4x Lifting chain or lifting cable

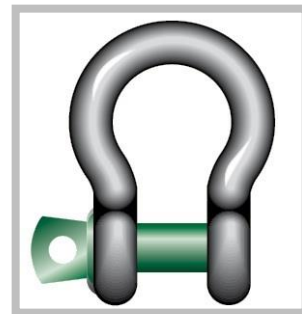
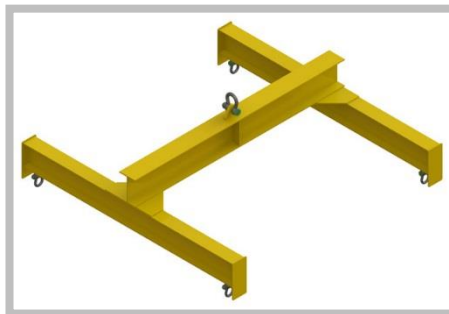

Step 1: Unpacking

The roof access hatch is delivered in a wooden box as standard. The box consists of separate front and side panels.

- A. First remove the lid and then the side walls one at a time. **Caution:** When the last two walls detach from one another they may fall over. Therefore make sure the walls are held in place.
- B. The roof access hatch is attached to the pallet. Remove the bolts so the roof access hatch is no longer attached to the pallet.

Step 2: Lifting

All TopLight roof access hatches are fitted with four lifting eyes, located on the hinge side and the opposite side. These can be used to lift the roof access hatch.

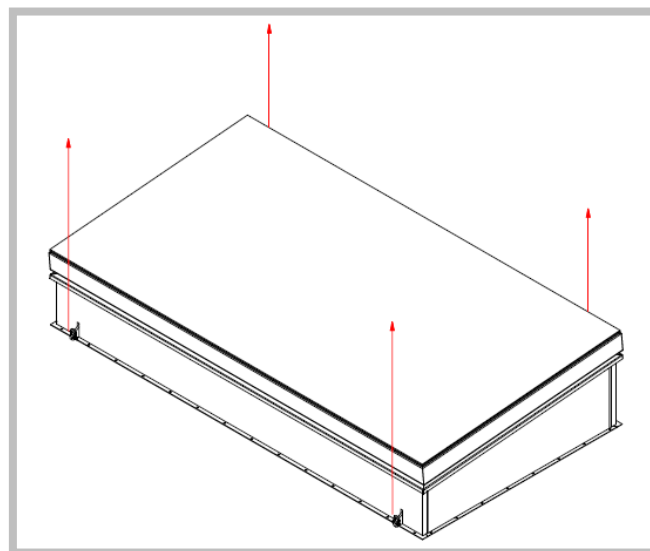

To prevent damage to the roof access hatches, the lifting cables from which the roof access hatch will hang must always be perfectly plumb. You must therefore use a double lifting beam.

- A. Place protection at the lifting points to prevent the lifting chains from damaging the frame or glazing.
- B. Hang the lifting beam from the crane and make sure it is properly installed and secured.

- C. Use shackles ('Green Pin G-4161 Screw Pin Bow Shackle' or equivalent) to attach the lifting chains/lifting cables to the lifting eyes.

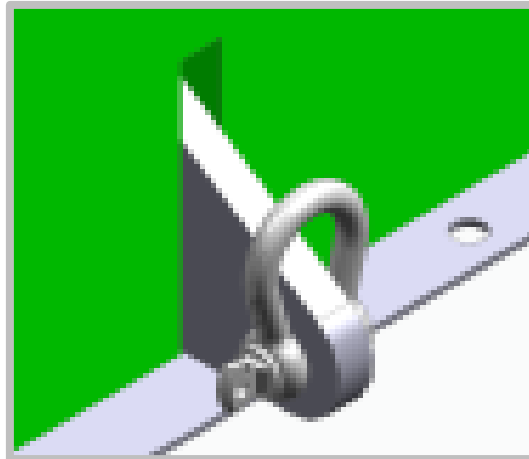

- D. Use the crane to position the lifting beam above the roof access hatch.
- E. Attach the lifting chains (which are attached to the roof access hatch) to the lifting frame. Make sure the lifting cables/chains are not under tension and that they do not touch the roof access hatch or the glazing.
- F. Carefully lift the roof access hatch to the roof and over the roof opening. Align the roof access hatch above the roof opening and carefully lower the roof access hatch onto the roof. CAUTION! It is important that the lifting straps/chains pull straight up to avoid subjecting the lifting eyes to potentially damaging stresses.
- G. Once the hatch is in the correct position the lifting cables/chains can be detached from the double lifting beam. Make sure the cables/chains are not placed on and do not fall on the glazing after they are detached.
- H. Detach the lifting cables from the roof access hatch.
- I. The final installation and sealing of the roof access hatch can now be completed, as explained in our installation instructions.